

RECITAL VENUE MAP!

If your dancer has a costume change, a parent needs to return to the dressing room to help change into the next costume, and then move your dancer to their next class so they can line up.

ALL DANCERS:

Follow this path from the parking lot to the dressing rooms.

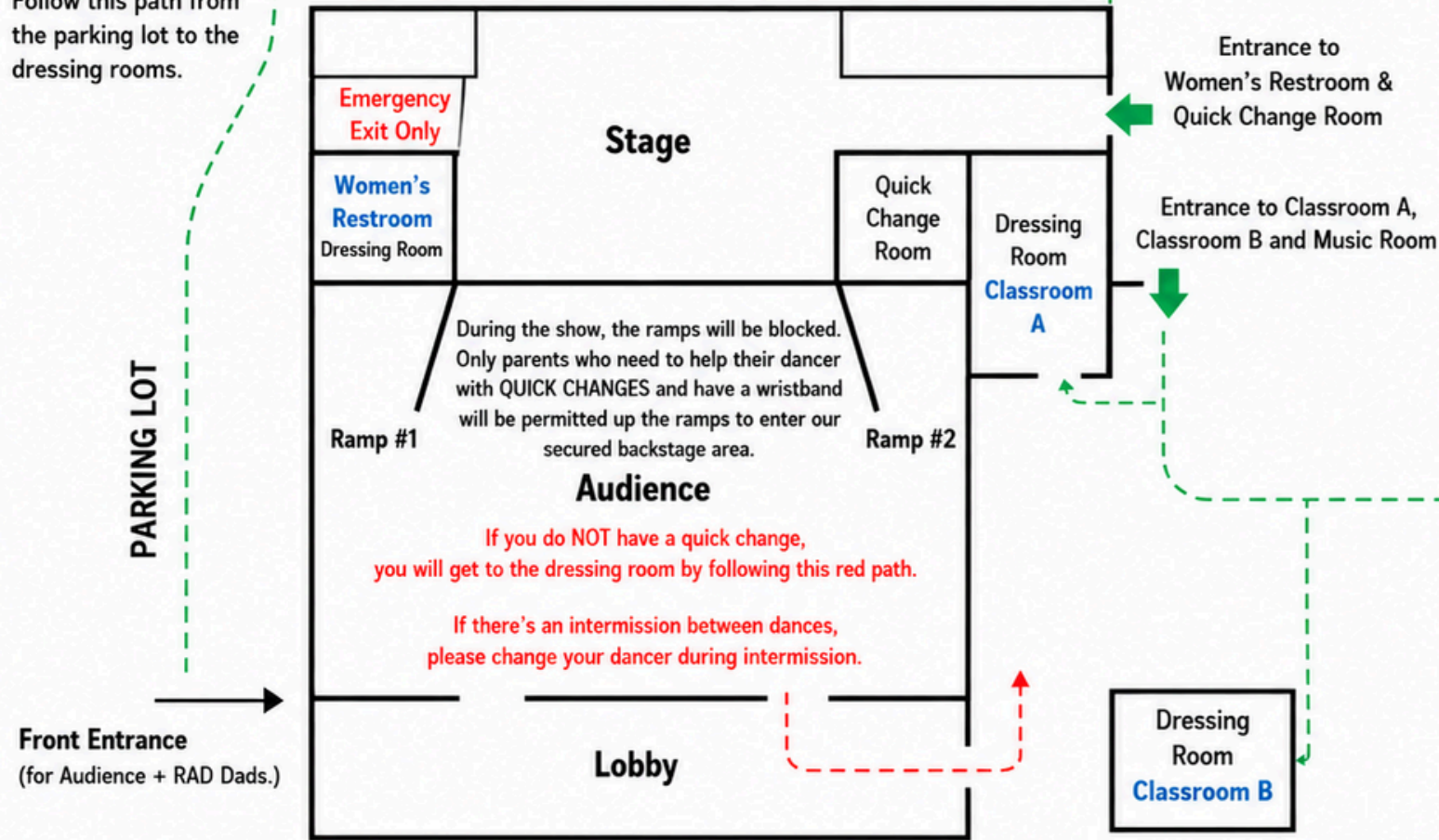

QUICK CHANGES

for those assigned to Classroom A, Classroom B or the Music Room.

The Men's Restroom will be used for **QUICK** changes only.

When you arrive, put the quick change costume and shoes in the quick change room so it's ready for you when it's time to change!

If there's an intermission between your dancer's dances, or you **do not** have a quick change, you will go to the dressing room to change your dancer.

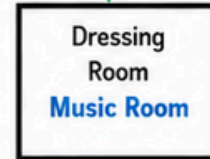

SCAN BELOW FOR A VIDEO WALK THROUGH OF THE VENUE



Classroom A

- Jazz+Tap Ages 6-7
- Jazz+Hip Hop Ages 6-9
- Ballet Ages 6-9
- Hip Hop Ages 6-9
- Ballet Ages 8-9
- Jazz+Tap Ages 8-9

Classroom B

- Hip Hop Juniors
- Contemporary Juniors
- Musical
- Ballet Ages 10-12

Music Room

- Twinkle Tots Ages 2-3
- Ballet+Tap Ages 3-4
- Ballet+Tap Ages 4-5
- Hip Hop Minis Ages 3-5

Women's Restroom

- Adv. Contemporary
- Jazz+Tap Elites
- Hip Hop Elites
- Contemporary Elites
- Ballet Ages 13+